



JAMINI ROY COLLEGE

(NAAC Accredited - B)

P.O. - BELIATORE, DIST.- BANKURA (W.B.), PIN - 722203

TEL. No. : 03241-259261, Email ID - jamini.roy.college.261@gmail.com

Ref. No.

Date 25/11/22

From :

Principal / Teacher Incharge
Jamini Roy College
Beliatore, Bankura

Tender Notice No - 21

এতদ্বারা যামিনী রায় কলেজের লাইব্রেরী বিল্ডিং এর নিচের তলার সিঁড়ির কাজের জন্য, সিল করা দরপত্র আহবান করা হচ্ছে। দরপত্রটি কলেজ অফিসে জমা দেওয়ার শেষ তারিখ (02/12/22) বৈকাল তিনটার মধ্যে। দরপত্রে অতি অবশ্যই কন্টাক্ট নাম্বার থাকতে হবে। কাজের ব্যাপারে বিশদ জানার জন্য যামিনী রায় কলেজের ওয়েবসাইট অনুসরণ করার জন্য জানানো হচ্ছে। দরপত্র খোলার দিন (03/12/22) দুপুর একটার মধ্যে।

দরপত্র খোলার সময় বিডারদের উপস্থিত থাকা বাধ্যতামূলক নয়।

অধ্যক্ষ

যামিনী রায় কলেজ

Principal
Jamini Roy College
Beliatore, Bankura (W.B.)

ESTIMATE FOR MODIFICATION OF LIBRARY BUILDING GROUND FLOOR STAIR AT BELIATORE JAMINI ROY COLLEGE AT BELIATORE IN THE DISTRICT OF BANKURA.

Sl. No.	Description of Items	No.	Length	Breath	Height	Quantity	Unit	Rate	Amount
			Meter	Meter	Meter			₹	₹
1	BW: I-B-1-a, P-10 Dismantling all types of masonry excepting cement concrete plain or reinforced, stacking serviceable materials at site and removing rubbish as directed within a lead of 75 m.a) In ground floor including roof.	2	2.700	0.100	0.750	0.405			
	Partition wall					0.405	CUM.	447.00	181.04
2	BW: I-B-1, P-192 Labour for Chipping of concrete surface before taking up plastering work. Stair floor	1	2.750	1.500		4.125			
		1	2.000	3.050		6.100			
		1	2.000	1.500		3.000			
		1	1.500	1.500		2.250			
		1	1.500	1.500		2.250			
					17.725	SqM.	21.00	372.23	
3	BW: I-C-8-a & b, P-15 Brick Work with 1st class brick in cement mortar (6:1) (a) In foundation and plinth Ground Floor (b) In superstructure, ground floor steps	9	1.500	0.300	0.150	0.608			
		9	1.500	0.300	0.250	1.013			
						1.620	CUM.	4683.06	7586.56
	Total Quantity								
4	BW: I-C-21 & b, P-17 (b) 75 mm. thick brick work with 1st class bricks set in cement, sand mortar (1:3) in ground floor including H. B. netting in every alternate layers. Railing	2	2.700		0.750	4.050			
		1	0.900		0.750	0.675			
						4.725	SqM.	475.77	2248.01
5	BW: I-L-1-i-b&c, P-189 Plaster (to wall, floor, ceiling etc.) with sand and cement mortar including rounding off or chamfering corners as directed and raking out joints including throating, nosing and drip course, scaffolding/staging where necessary (Ground floor). [Excluding cost of chipping over concrete surface] (b) 15 mm thick plaster (ii) With 1:6 cement mortar	4	2.700		1.000	10.800			
		2	1.000		1.000	2.000			
						12.800	Sq.M.	132.55	1696.64
	Total Quantity								

ARINDAM KARMAKAR
 DMC/BPD/LBS-II/213
 Barjora, Bankura

Principal,
 Jamini Roy College
 Beliatore, Bankura (W.B.)

Sl. No.	Description of Items	No.	Length Meter	Breath Meter	Height Meter	Quantity	Unit	Rate	Amount	
								₹	₹	
6	BW: I-K-5-b, P-204 Rendering the surface of wall and ceiling with white cement based wall putty of approved make and brand (1.5 mm thick.) (Asian Paints) Chamber	4	2.700	1.000		10.800				
		2	1.000	1.000		2.000				
		4	2.700	0.300		3.240				
						16.040	Sq.M.	110.00	1764.40	
7	BW: I-K-6-a, P-204 Cleaning the walls and ceiling by scraping and papering and smoothening down the surface including pitting Chamber	4	2.700	1.000		10.800				
		2	1.000	1.000		2.000				
		4	2.700	0.300		3.240				
						16.040	Sq.M.	17.00	272.68	
8	BW: I-J-7-b-i, P-195 Applying Interior grade Acrylic Primer of approved quality and brand on plastered or concrete surface old or new surface to receive Distemper/ Acrylic emulsion paint including scraping and preparing the surface thoroughly, complete as per manufacturer's specification and as per direction of the E.C. (In Ground Floor) Two coats (I) Water based interior grade Acrylic Primer (Asian Paints) Same as putty				16.040	%Sq.M.	4420.00	708.97		
9	BW: I-J-10, P-196 Acrylic Distemper to interior wall, ceiling with a coat of solvent based interior grade acrylic primer (as per manufacturer's specification) including cleaning and smoothening of surface. Two coats (Asian Paints) same as Interior grade Acrylic Primer				16.040					
10	BW: I-U-1, P-280 Supplying and laying true to line and level Anti-Skid, Full Body, Homogeneous & Granular finish Vitrified Tiles conforming to IS:15622-2006 & IS 4457-2007 and testing shall be made in accordance with IS:13630 [Non- modular sizes for tiles with Skid resistance > 0.5, Mohr's hardness > 5.0, Staining resistance: Class-1, Water Absorption: E < 0.5%, MOR > 35 N/sq.mm in Internal area of building e.g. Toilet Block, Passage, Corridor, Accessible Open Terrace etc. set in 20 mm sand cement mortar (1:4) and 2 mm thick cement slurry at back side of tiles using cement @ 2.91 Kg/Sqm or using Polymerised Adhesive (6 mm thick layer applied directly over finished artificial stone floor/ Mosaic etc without any backing course) laid after application slurry using 1.75 Kg of cement per Sqm below mortar only, joints grouted with admixture of white cement and colouring pigment to match with colour of tiles/ epoxy grout materials of approved make as directed and removal of wax coating of top surface of tiles with warm water and polishing the tiles using soft and dry cloth upto mirror finish complete including the cost of materials, labour and all other incidental charges complete true to the manufacturer's specification and direction of Engineer-in-Charge. (White cement, synthetic adhesive and grout material to be supplied by the contractor). a) In Ground Floor: Sizes-300 mm x300mm x10 mm with breaking strength > 1200 N	18	1.500	0.300		8.100				



ARINDAM KARMAKAR

 DMC/BPD/LBS-II/213

Principal,

Jamini Roy College

 Beliatore, Bankura (W.B.)

Sl. No.	Description of Items	No.	Length Meter	Breath Meter	Height Meter	Quantity	Unit	Rate		Amount	
								₹	₹	₹	₹
		20	1.500	0.150		4.500					
		40	0.300	0.300		3.600					
		1	3.050	2.000		6.100					
		2	2.000	0.300		1.200					
		1	3.050	0.300		0.915					
						24.415	Sq.M.	897.00		21900.26	
	Total							₹		37853.58	
	Add 18% for GST							₹		6813.64	
	Gross Total							₹		44667.22	
	Add 1% for Labour Cess							₹		446.67	
	Net Total							₹		45113.90	
	Add 3% Contingency							₹		1353.42	
	All Total							₹		46467.31	
	Say							₹		46,467.00	

(Rupees Forty Six Thousand Four Hundred Sixty Seven Only)

Payment will be made for all items after finishing as per EIC as per Govt. norms.

This Estimate prepared on the basis of PWD Schedule of Rates, West Bengal, effective from 01.11.2017 of South Western Circle, Bankura Division. (15TH CORRIGENDA & ADDENDA)

Principal,
Jamini Roy College (N.B.)
Bellatore, Bankura

ARINDAM KARMAKAR
DMC / BSRD / BSR II / 213
Barjore, Bankura

Signature of Principal

LIBRARY BUILDING GROUND FLOOR STAIR MODIFICATION
 AT BELIATORE JAMINI ROY COLLEGE, BANKURA

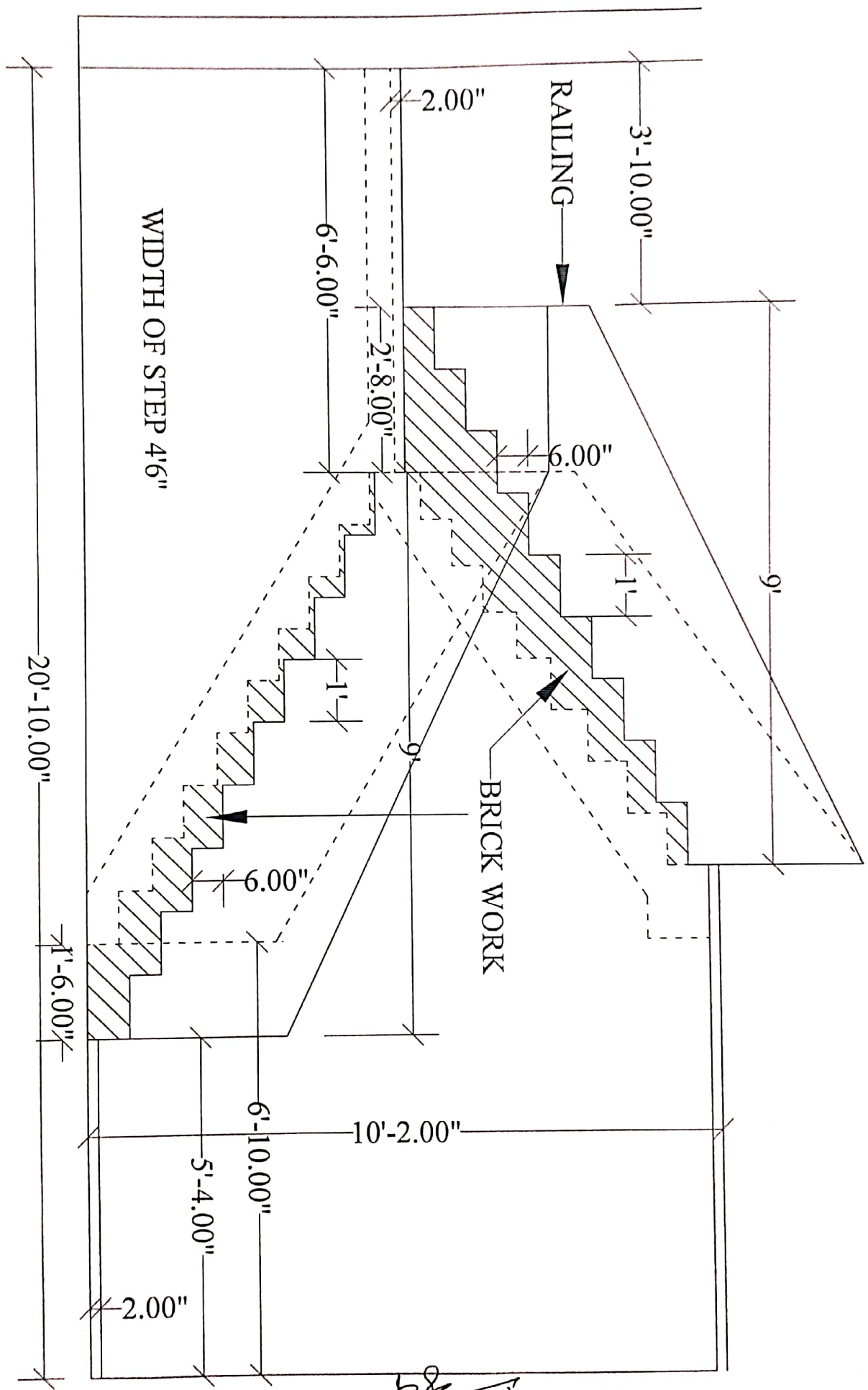

Principal,
 Jamini Roy College
 Beliatare, Bankura (W.B.)

ARINDAM KARMAKAR
 DMC/Arch/LBS-II/213
 Bankura, Bankura

Materials Road Transport, Carriage and Loading & Unloading Cost Analysis

Carriage of 20 mm. Stone Chips	Bankura		1482.00 per Cum.	
Carriage of 10 mm. Stone Chips	Bankura		1351.00 per Cum.	
Carriage of Stone Chips	Upto 5 Km.			124.00
	5 - 10 Km.		5 x 10.90	54.50
	10 - 20 Km.		10 x 10.10	101.00
	20 - 35 Km.		15 x 9.50	142.50
	1:1.5:3			
Carriage for 35 Km.		(124.00+54.50+101.00+142.50) x 0.86		362.92
Loading & Unloading of 20 mm. Stone Chips	35 Km.		0.57300 x 58.00	33.23
Loading & Unloading of 10 mm. Stone Chips	35 Km.		0.287 x 58.00	16.65
	1:2:4			
Carriage for 35 Km.		(124.00+54.50+101.00+142.50) x 0.88		371.36
Loading & Unloading of 20 mm. Stone Chips	35 Km.		0.5870 x 58.00	34.05
Loading & Unloading of 10 mm. Stone Chips	35 Km.		0.2930 x 58.00	16.99
Carriage of Reinforcement Steel	Upto 5 Km.			82.00
	5 - 10 Km.		5 x 7.30	36.50
	10 - 20 Km.		10 x 6.70	67.00
	20 - 25 Km.		5 x 6.30	31.50
				217.00
Carriage of Reinforcement Steel for 25 Km.		(82.00+36.50+67.00+31.50) x 1.05		227.85
Loading & Unloading of Reinforcement Steel			1.05 x 72.00	75.60

 Principal,
 Jamini Roy College
 Beliatore, Bankura (W.B.)

ARINDAM KARMAKAR
 DMC/WRD/ENR-II/213
 Barjisa, Bankura

Rate Analysis for Cement Work & Reinforcement Steel Work

CEMENT ISSUE RATE (IR)	6289.00		Carriage	Cement	20 Km.	Reinforcement Steel Issue Rate (IR)	42792.00					
CEMENT BASIC RATE (BR)	5717.00			Steel	25 Km.	Reinforcement Steel Basic Rate (IR)	37844.00					
SL. NO.	ITEM	Qty. (Cum)	Qty. of Cement - A (MT)	Rate	Schedule Rate	Carriage	Loading & Unloading	Total	A x IR (-)	MT x BR (+)	Final Rate	Unit
1	RCC 1:1.5:3											
	Cement	0.28600	0.40857		4888.00			4888.00				
	Stone Cips 20 mm.	0.57300		1482.00	849.19		33.23	882.42				
	Stone Cips 10 mm.	0.28700		1351.00	387.74		16.65	404.38				
						362.92		362.92				
								6537.72	2569.51	2335.80	6304.01	Cum.
2	RCC 1:2:4											
	Cement	0.22000	0.31429		4882.00			4882.00				
	Stone Cips 20 mm.	0.58700		1482.00	869.93		34.05	903.98				
	Stone Cips 10 mm.	0.29300		1351.00	395.84		16.99	412.84				
						371.36		371.36				
								6570.18	1976.57	1796.80	6390.41	Cum.
3	Reinforcement Steel		1.17000		60003.00	227.85	75.60	60306.45	50066.64	44277.48	54517.29	MT
	(JSW/Shyam Steel/SRMB)				4728.00			4728.00	494.14	449.19	4683.06	Cum.
4	Brick work (1:6)	0.05500	0.07857		625.00			625.00	82.13	74.66	617.53	Sqm.
	(Super Structure)				482.00			482.00	68.49	62.26	475.77	Sqm.
5	125 mm. Brick work (1:4)	0.00914	0.01306		153.00			153.00	35.94	32.67	149.73	Sqm.
	(Super Structure)				135.00			135.00	26.95	24.50	132.55	Sqm.
6	75 mm. Brick work (1:3)	0.00762	0.01089		153.00			153.00	26.95	24.50	132.55	Sqm.
	(Super Structure)				135.00			135.00	26.95	24.50	132.55	Sqm.
7	Plaster 20 mm. (1:6)	0.00400	0.00571		34.00			34.00	13.65	12.41	32.76	Sqm.
	(Super Structure)				260.00			260.00	76.79	69.80	253.01	Sqm.
8	Plaster 15 mm. (1:6)	0.00300	0.00429		260.00			260.00	76.79	69.80	253.01	Sqm.
	(Super Structure)											
9	Neat Cement Punning	0.00152	0.00217									
10	A.S.F.	0.00855	0.01221									

 Principal,
 Jamini Roy College
 Bellatore, Bankura (M.B.

ARINDAM KARMAKAR
 DMC/BPD/LBS-II/213
 Barjora, Bankura